

Stainless Steel Vertical Multistage Pump — 60Hz — SVM(T)4

Applications

- Water supply
- Industry pressure boosting
- Industry liquid transfer
- Water treatment
- Irrigation

Motor

- Full - enclosed, air-blast two - pole standard motor
- Protection: IP 55
- Insulation class: F
- Standard voltage: 3x200-230/346-400V (60Hz)
 - 3x220-255/380-440V
 - 3x220-277/380-480V

Operation conditions

- Thin, clean, non-flammable and non - explosive liquid containing no solid granules and fibers.
- Liquid Temperature:
 - Normal temperature: +15°C~+70°C
 - Hot water: -15°C~+105°C
- Ambient Temperature: up to +40°C
- Altitude: up to 1000m

Material

- Inlet & outlet chamber: Cast iron/Stainless steel (304/316)
- Impeller: Stainless steel (304/316)
- Shell: Stainless steel (304/316)
- Shaft: Stainless steel (304/316)
- Coupling: Ductile iron
- Bearing: Tungsten carbide
- Mechanical seal: Tungsten Carbide / Graphite

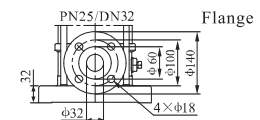
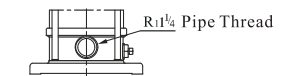
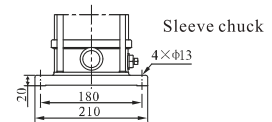
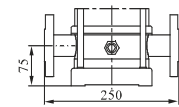
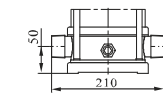
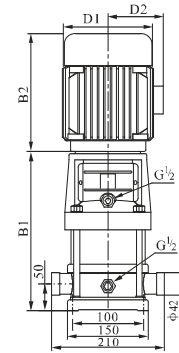

Performance table

Model	Driving motor		Q (m ³ /h)	2.5	3	4	5	6	7	8
	(kW)	(hp)								
SVM4-20	0.75	1		26	25	23	21	19	16	14
SVM4-30	1.1	1.5		39	38	36	32	28	24	21
SVM4-40	1.5	2		52	50	48	44	38	35	31
SVM4-50	2.2	3		65	62	60	55	49	44	39
SVM4-60	2.2	3		78	75	72	67	59	54	47
SVM4-70	3	4	H (m)	92	88	84	78	69	62	55
SVM4-80	3	4		104	100	95	90	79	72	63
SVM4-100	4	5.5		130	125	120	113	102	90	80
SVM4-120	4	5.5		156	150	145	136	122	109	96
SVM4-140	5.5	7.5		182	176	170	159	145	129	112
SVM4-160	5.5	7.5		207	201	196	183	165	146	128

Stainless Steel Vertical Multistage Pump — 60Hz — SVM(T)4

Performance Curves

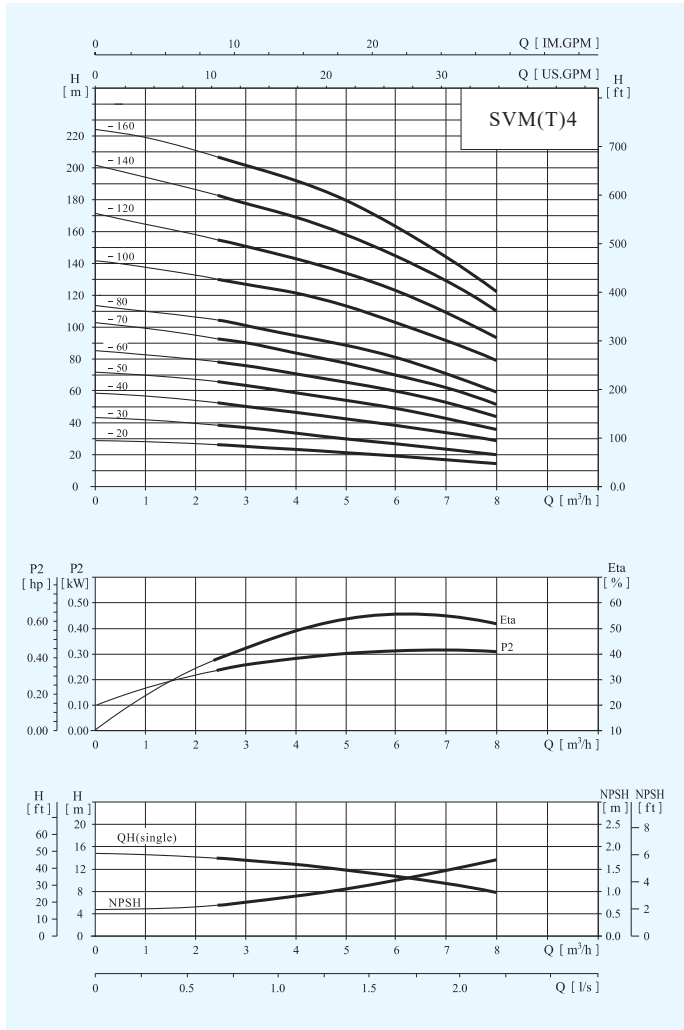

Model Description

SVM(T)1/2/3/4/5/8/10/12/15/16/20

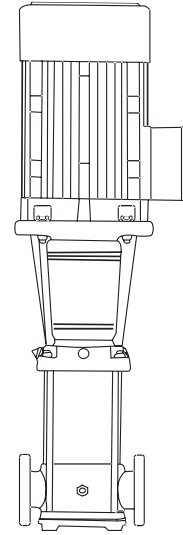

SVM/VSMT

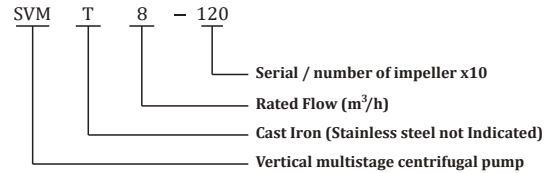

Size and weight

Model	Size (mm)					Weight (kg)
	B1	B2	B1+B2	D1	D2	
SVM4-20	286	245	531	170	142	24
SVM4-30	313	245	558	170	142	25
SVM4-40	350	290	640	190	155	31
SVM4-50	376	290	667	190	155	34
SVM4-60	404	290	694	190	155	35
SVM4-70	441	315	756	197	165	42
SVM4-80	468	315	783	197	165	42
SVM4-100	522	335	857	230	188	51
SVM4-120	576	335	911	230	188	52
SVM4-140	650	430	1080	260	208	64
SVM4-160	704	430	1134	260	208	66

Stainless Steel Vertical Multistage Pump — 60Hz — SVM(T)4

Structure chart:SVM(T)1/2/3/4/5

Material:SVM(T)1/2/3/4/5

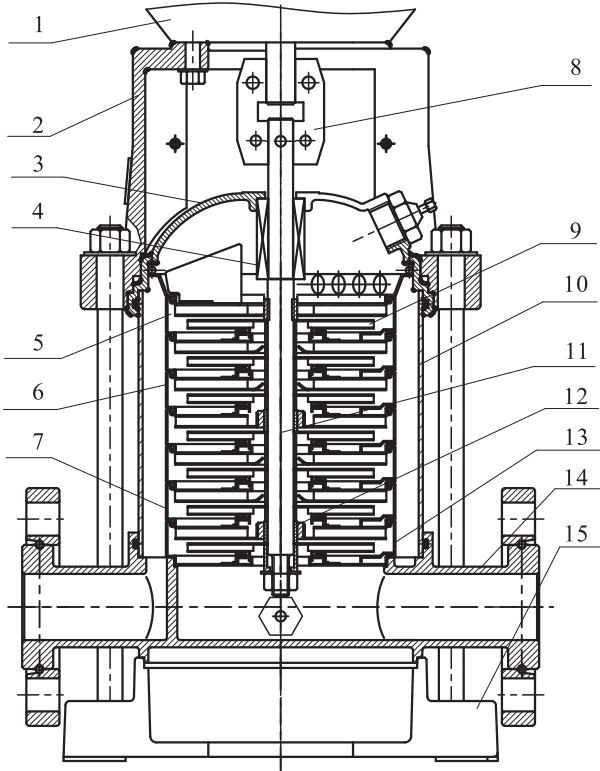

SVM

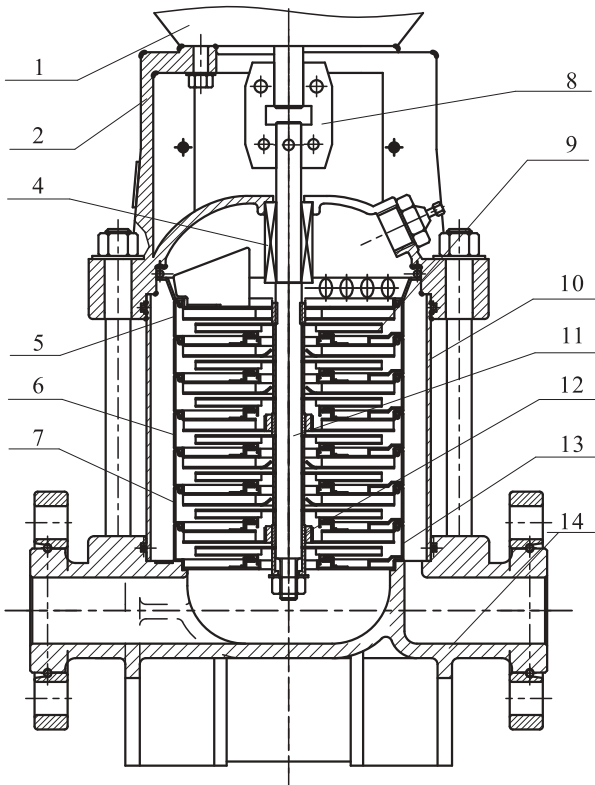

SVMT

No	Description	Material	AISI/ASTM
1	Motor	Assembling unit	
2	Support	Cast Iron/ Ductile iron	ASTM25B ASTM70-50-05
3	seal seat	Stainless Steel	AISI304
4	Mechanical seal	Assembling unit	
5	Outlet guide vane	Stainless Steel	AISI304
6	Guide vane	Stainless Steel	AISI304
7	Support guide vane	Stainless Steel	AISI304
8	Coupling	Ductile iron	ASTM70-50-05
9	Impeller	Stainless Steel	AISI304
10	Shell	Stainless Steel	AISI304
11	Pump Shaft	Stainless Steel	AISI304 AISI316L
12	Bearing	Tungsten Carbide	
13	Inlet guide vane	Stainless Steel	AISI304
SVM			
14	Inlet & outlet seat	Stainless Steel	AISI304
15	Seat	Cast Iron	ASTM25B
SVMT			
14	Inlet & outlet seat	Cast Iron	ASTM25B