

Stainless Steel Vertical Multistage Pump — SVM(T)16

Applications

- Water supply
- Industry pressure boosting
- Industry liquid transfer
- Water treatment
- Irrigation

Motor

- Totally enclosed, air-cooled secondary standard motor
- Degree of protection: IP 55
- Insulation class: F
- Standard voltage: 1x220-230/240V (50Hz)
 - 3x200-220/346-380V
 - 3x220-240/380-415V
 - 3x220-255/380-440V
- Other voltage of the motor is available on request.
- Single phase motors from 0.37kW-2.2kW are available on request

Operation conditions

- Thin, clean, non-flammable and explosive and not containing solid particles or fibers liquid.
- Liquid Temperature:
 - Normal temperature: +15°C~+70°C
 - Hot water: -15°C~+105°C
- Environment Temperature: Max. 40°C
- Altitude: Max. 1000m

Material

- Inlet & outlet chamber: Cast iron/Stainless steel (304/316)
- Impeller: Stainless steel (304/316)
- Shell: Stainless steel (304/316)
- Shaft: Stainless steel (304/316)
- Coupling: Ductile iron
- Bearing: Tungsten carbide
- Mechanical seal: Tungsten Carbide / Graphite

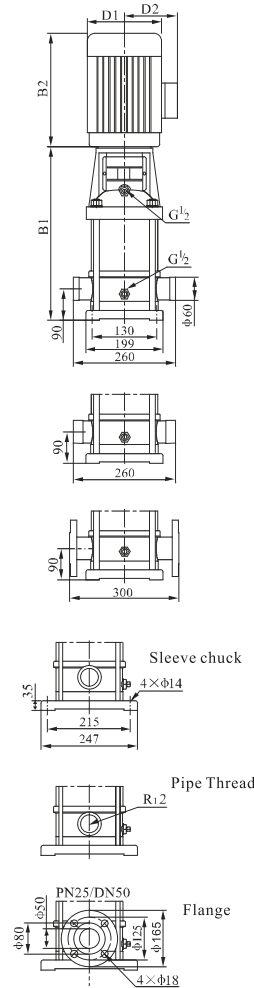

Performance Table

Model	Associated motor(kW)	Q (m ³ /h)	8	10	12	14	16	18	20	22
SVM16-20	2.2	H (m)	27	26	25	24	22	21	19	16
SVM16-30	3.0		41	40	38	37	34	32	29	25
SVM16-40	4.0		54	53	52	49	46	43	38	34
SVM16-50	5.5		68	67	65	62	58	54	48	43
SVM16-60	5.5		82	80	78	74	70	64	58	52
SVM16-70	7.5		96	95	91	87	82	76	68	61
SVM16-80	7.5		110	108	104	99	94	86	77	70
SVM16-100	9.2		138	136	131	125	118	109	97	87
SVM16-120	11		166	162	157	150	141	130	116	105
SVM16-140	15		194	190	184	175	166	152	136	122
SVM16-160	15		222	217	210	200	189	174	156	140

Stainless Steel Vertical Multistage Pump SVM(T)16

Performance Curves

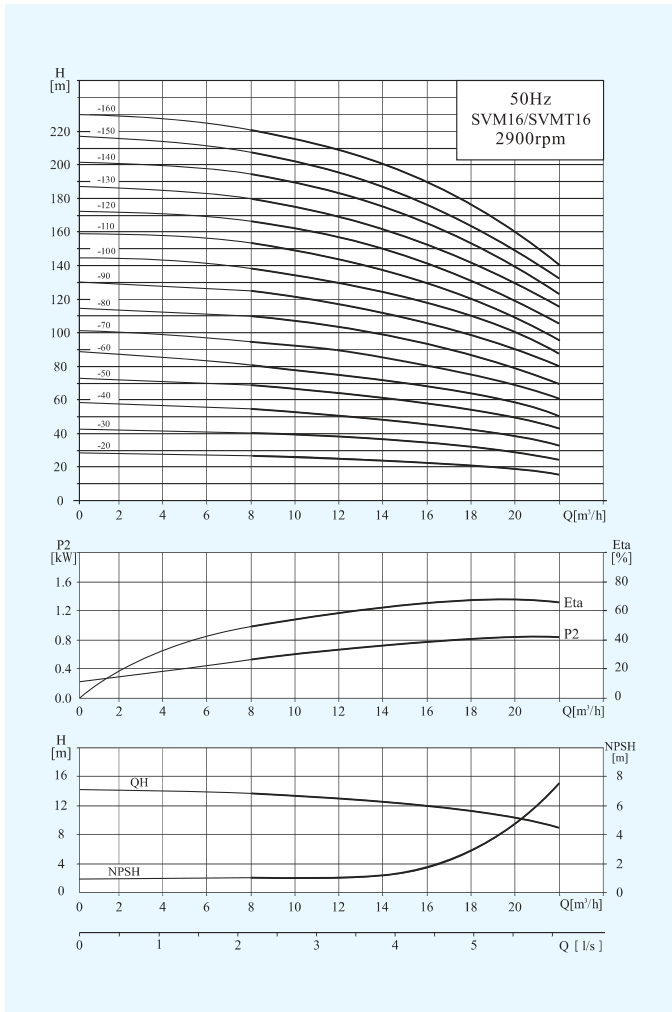

Model Description

SVM(T)1/2/3/4/5/8/10/12/15/16/20

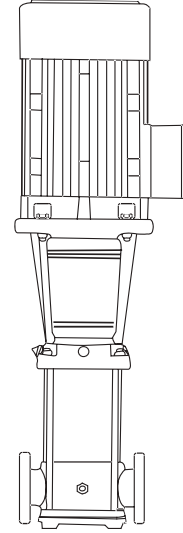

SVM/SVMT

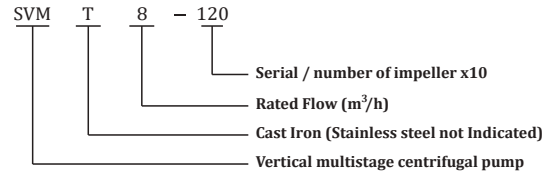

Dimension&Weight

Model	Size (mm)					Net Weight(kg)
	B1	B2	B1+B2	D1	D2	
SVM16-20	397	290	687	190	155	42
SVM16-30	452	345	797	197	165	50
SVM16-40	497	355	852	230	188	59
SVM16-50	562	390	952	260	208	76
SVM16-60	607	390	997	260	208	77
SVM16-70	652	390	1042	260	208	84
SVM16-80	697	390	1087	260	208	86
SVM16-100	787	390	1177	260	208	106
SVM16-120	965	500	1465	330	255	161
SVM16-140	1055	500	1555	330	255	174
SVM16-160	1145	500	1645	330	255	178

Stainless Steel Vertical Multistage Pump — SVM(T)16

Structure chart: SVM(T)8/10/12/15/16/20

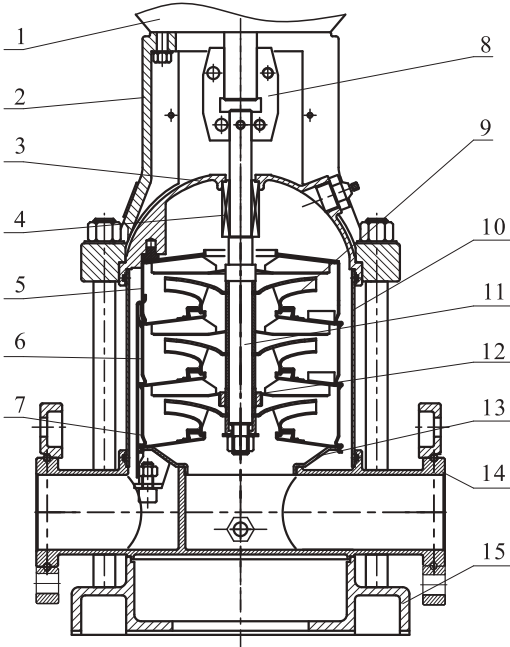

SVM

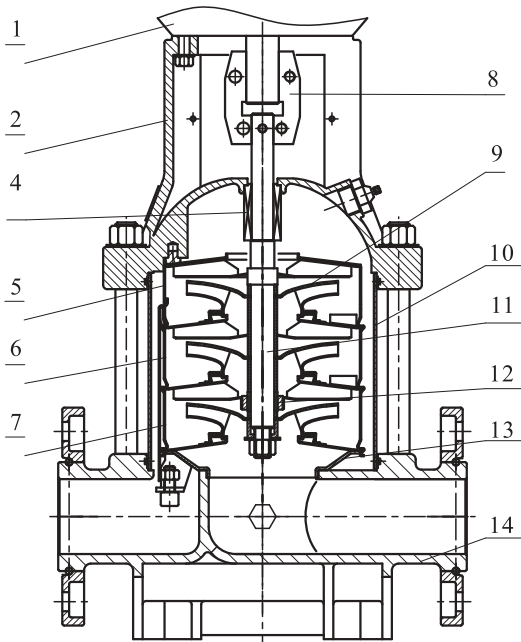

SVMT

Material:SVM(T)8/10/12/15/16/20

No	Description	Material	AISI/ASTM
1	Motor	Assembling unit	
2	Support	Cast Iron/ Ductile iron	ASTM25B ASTM70-50-05
4	Mechanical seal	Assembling unit	
5	Outlet guide vane	Stainless Steel	AISI304
6	Guide vane	Stainless Steel	AISI304
7	Support guide vane	Stainless Steel	AISI304
8	Coupling	Ductile iron	ASTM70-50-05
9	Impeller	Stainless Steel	AISI304
10	Shell	Stainless Steel	AISI304
11	Pump Shaft	Stainless Steel	AISI304 AISI316L
12	Bearing	Tungsten Carbide	
13	Inlet guide vane	Stainless Steel	AISI304
SVM			
3	seal seat	Stainless Steel	AISI304
14	Inlet & outlet seat	Stainless Steel	AISI304
15	Seat	Cast Iron	ASTM25B
SVMT			
14	Inlet & outlet seat	Cast Iron	ASTM25B