

Vertical Multistage Centrifugal Pump — SVH | SVHT 8

Applications

Water supply

- Water filter
- Supercharging
- Pressurization of hotels
- Industrial pressurization

Industrial boosting

- Cleaning system
- High pressure flushing system
- Firefighting system
- Car cleaning equipment

Industrial liquid transport

- Cooling air conditioning system
- Boiler feed water
- Condensing system and cooling tower
- Machine tool cooling lubrication system

Water treatment

- Ultrafiltration system
- Reverse osmosis system
- Distillation system
- Separator
- Swimming pool

Irrigation

- Regional irrigation
- Sprinkler irrigation
- Drip irrigation
- Greenhouse irrigation

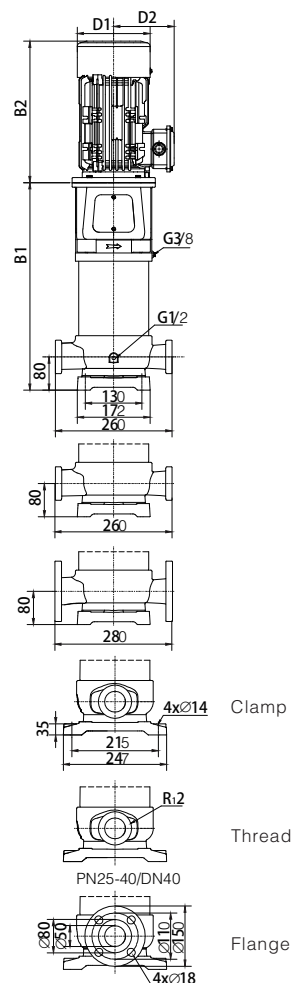

Dimensions and Weight

Model	Dimension (mm)					Weight (kg)
	B1	B2	B1+B2	D1	D2	
SVH8-20-2	355	280	635	170	142	36
SVH8-20	355	280	635	170	142	38
SVH8-30-1	395	350	745	190	155	46
SVH8-30	395	350	745	190	155	50
SVH8-40	425	350	775	190	155	51
SVH8-50	465	410	875	196	165	58
SVH8-60-2	495	410	905	196	165	59
SVH8-60	495	410	905	230	185	68
SVH8-70	525	410	935	230	185	69
SVH8-80	555	410	965	230	185	70
SVH8-90	605	465	1070	260	210	96
SVH8-100	635	465	1100	260	210	97
SVH8-110-1	665	465	1130	260	210	98
SVH8-110	665	465	1130	260	210	105
SVH8-120	695	465	1160	260	210	106
SVH8-130	725	465	1190	260	210	107
SVH8-140-1	755	465	1220	260	210	108
SVH8-140	844	610	1454	350	260	162
SVH8-150	874	610	1484	350	260	163
SVH8-160	904	610	1514	350	260	164
SVH8-170	934	610	1544	350	260	165
SVH8-180	964	610	1574	350	260	166
SVH8-190	994	610	1604	350	260	174
SVH8-200	1024	610	1634	350	260	175
SVH8-210	1054	610	1664	350	260	176
SVH8-220	1084	610	1694	350	260	177



G PUMP

Vertical Multistage Centrifugal Pump — SVH | SVHT 8

Performance curve

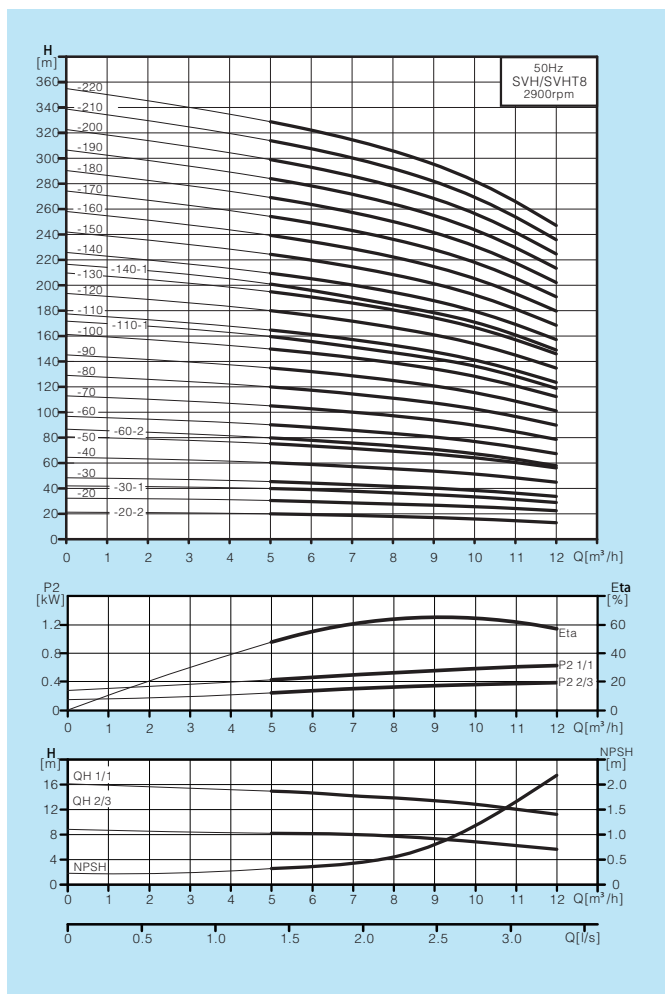

Model Specification

SVH,SVHT1/2/3/4/5/8/10/12/15/16/20

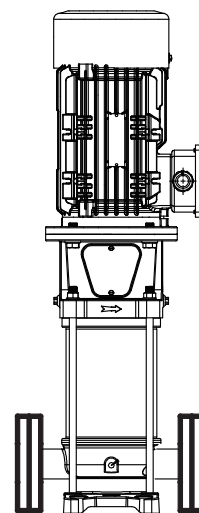

SVH / SVHT

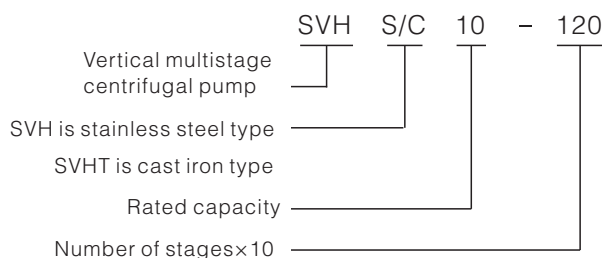

Performance data

Model	Power(kW)	Q (m³/h)	5	6	7	8	9	10	11	12
SVH8-20-2	0.75	H (m)	20	19.5	19	18	17	16	14	13
SVH8-20	1.1		30	29	28	27	26	25.5	24	22
SVH8-30-1	1.5		40	39	38	36	35	34	31	29
SVH8-30	2.2		45	44	42.5	41	40.5	38.5	36	34
SVH8-40	2.2		60	58.5	56.5	55	54	51	48	45
SVH8-50	3		75	73	71	68	68	64	60	56
SVH8-60-2	3		80	78	76	73	71	67	62	58
SVH8-60	4		90	88	85	82	81	77	72	67
SVH8-70	4		105	103	99	96	95	90	84	79
SVH8-80	4		120	117	113	110	108	103	96	90
SVH8-90	5.5		135	132	127	124	122	116	108	101
SVH8-100	5.5		150	147	142	137	135	128	121	112
SVH8-110-1	5.5		160	156	151	147	144	136	128	119
SVH8-110	7.5		165	161	156	151	149	141	133	124
SVH8-120	7.5		180	176	170	165	162	154	145	135
SVH8-130	7.5		195	191	184	179	176	167	157	146
SVH8-140-1	7.5		201	196	190	185	180	171	160	149
SVH8-140	11		210	205	198	193	189	180	169	157
SVH8-150	11		224	220	212	206	203	193	181	168
SVH8-160	11		239	235	226	220	216	205	193	180
SVH8-170	11	254	249	241	234	230	218	205	191	
SVH8-180	11	269	264	255	248	244	231	217	202	
SVH8-190	15	284	279	269	262	257	244	229	213	
SVH8-200	15	299	294	283	276	271	257	241	224	
SVH8-210	15	314	309	297	287	284	270	253	235	
SVH8-220	15	329	324	311	300	297	283	265	246	

Vertical Multistage Centrifugal Pump — SVH | SVHT 8

Structure SVH / SVHT 8,10,12,15,16,20

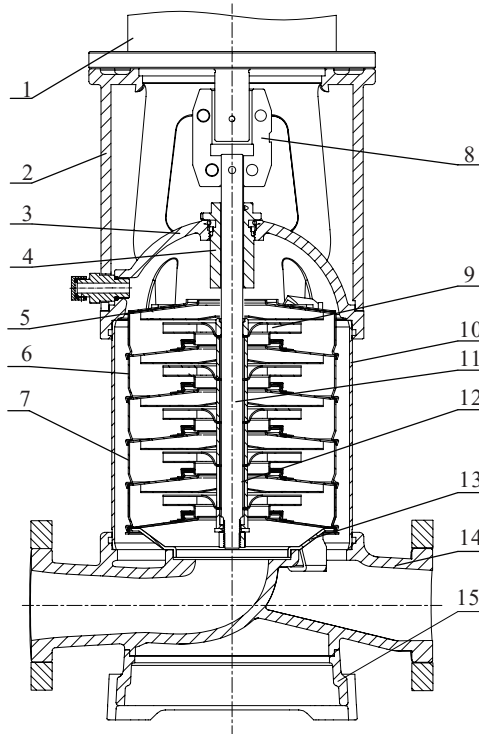

Materials SVH / SVHT 8,10,12,15,16,20

No.	Spare parts	Materials		GB		EN DIN		AISI/ASTM	
		SVHT	SVH	SVHT	SVH	SVHT	SVH	SVHT	SVH
1	Motor	/		/		/		/	
2	Bracket	Ductile cast iron		GB 1348-QT500-7		EN 1563 EN-GJS-500-7		ASTM A536 65-45-12	
3	Seal base	Ductile cast iron /Stainless steel		GB1348-QT500-7 /GB/T20878-06Cr19Ni10		EN 1563 EN-GJS-500-7 /EN 10088-1.4301		ASTM A536 65-45-12 /AISI304	
4	Mechanical seal	/		/		/		/	
5	Top diffuser	Stainless steel		GB/T20878-06Cr19Ni10		EN 10088-1.4301		AISI304	
6	Diffuser	Stainless steel		GB/T20878-06Cr19Ni10		EN 10088-1.4301		AISI304	
7	Support diffuser	Stainless steel		GB/T20878-06Cr19Ni10		EN 10088-1.4301		AISI304	
8	Coupling	Ductile cast iron		GB 1348-QT500-7		EN 1563 EN-GJS-500-7		ASTM A536 65-45-12	
9	Impeller	Stainless steel		GB/T20878-06Cr19Ni10		EN 10088-1.4301		AISI304	
10	Cylinder	Stainless steel		GB/T20878-06Cr19Ni10		EN 10088-1.4301		AISI304	
11	Shaft	Stainless steel		GB/T20878-06Cr19Ni10		EN 10088-1.4301		AISI304	
12	Bearing	WC/SiC		/		/		/	
13	Inducer	Stainless steel		GB/T20878-06Cr19Ni10		EN 10088-1.4301		AISI304	
14	Inlet & outlet chamber	Ductile cast iron /Stainless steel		GB1348-QT500-7 /GB/T20878-06Cr19Ni10		EN 1563 EN-GJS-500-7 /EN 10088-1.4301		ASTM A536 65-45-12 /AISI304	
15	Base	Ductile cast iron		GB 1348-QT500-7		EN 1563 EN-GJS-500-7		ASTM A536 65-45-12	