



G PUMP

## Vertical Multistage Centrifugal Pump — SVH | SVHT 160

### Applications

Water supply

- Water filter
- Supercharging
- Pressurization of hotels
- Industrial pressurization

Industrial boosting

- Cleaning system
- High pressure flushing system
- Firefighting system
- Car cleaning equipment

Industrial liquid transport

- Cooling air conditioning system
- Boiler feed water
- Condensing system and cooling tower
- Machine tool cooling lubrication system

Water treatment

- Ultrafiltration system
- Reverse osmosis system
- Distillation system
- Separator
- Swimming pool

Irrigation

- Regional irrigation
- Sprinkler irrigation
- Drip irrigation
- Greenhouse irrigation

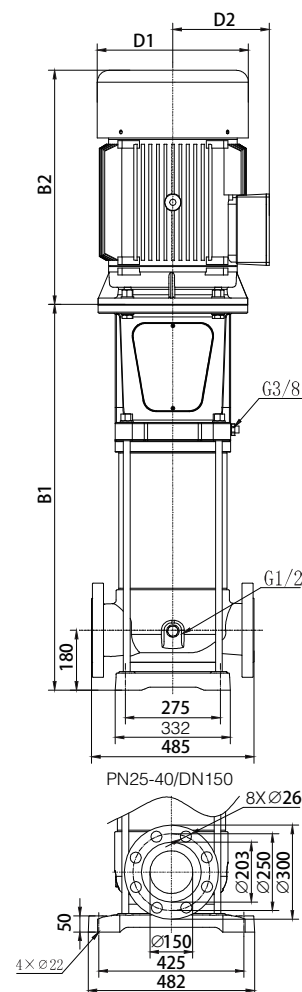

### Dimensions and Weight

Model	Dimension ( mm )					Weight (kg)
	B1	B2	B1+B2	D1	D2	
SVH160-10-1	787	610	1397	350	260	222
SVH160-10	787	610	1397	350	260	229
SVH160-20-2	909	670	1579	360	285	292
SVH160-20-1	909	715	1624	400	310	362
SVH160-20	909	715	1624	400	310	362
SVH160-30-2	1031	715	1746	400	310	385
SVH160-30-1	1031	740	1771	460	340	457
SVH160-30	1031	740	1771	460	340	457
SVH160-40-2	1183	820	2003	550	370	573
SVH160-40-1	1183	820	2003	550	370	573
SVH160-40	1183	870	2053	580	410	682
SVH160-50-2	1305	870	2175	580	410	696
SVH160-50	1305	870	2175	580	410	696
SVH160-60	1427	920	2347	580	410	752
SVH160-70	1549	1060	2609	660	550	1152
SVH160-80-2	1671	1060	2731	660	550	1161



G PUMP

# Vertical Multistage Centrifugal Pump — SVH | SVHT 160

## Performance curve

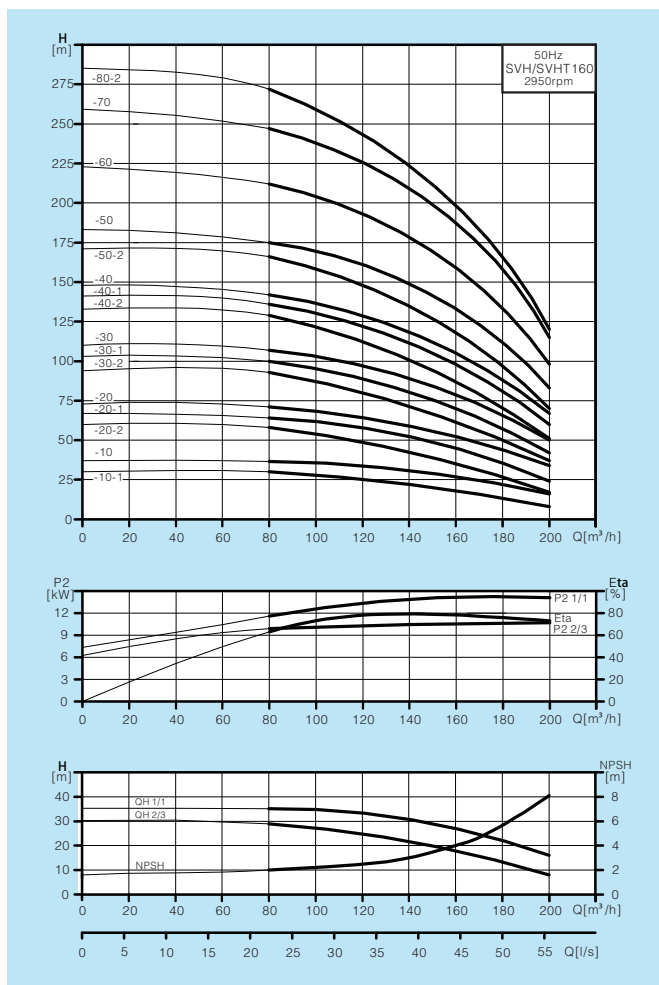

## Model Specification

SVH, SVHT 100/130/160/190

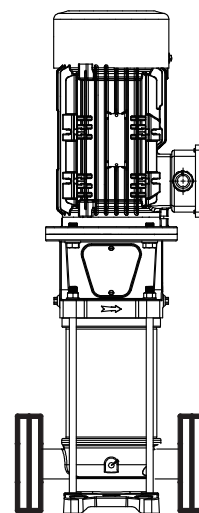

## SVH / SVHT

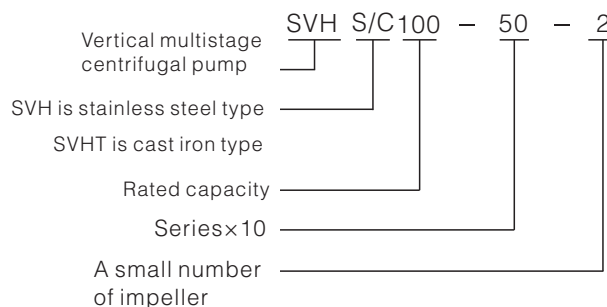

## Performance data

Model	Power(kW)	Q (m³/h)	80	90	100	110	120	130	140	150	160	170	180	190	200
SVH160-10-1	11	H (m)	29	28	27	26	25	23	21	20	18	16	14	11	8
SVH160-10	15		35	34	33	32	31	30	29	28	27	24	21	19	16
SVH160-20-2	22		58	56	54	51	48	45	42	39	35	31	27	22	17
SVH160-20-1	30		64	62	60	58	56	53	50	48	45	40	35	30	24
SVH160-20	30		71	68	67	66	64	61	58	55	52	48	44	39	34
SVH160-30-2	37		93	91	89	85	81	77	72	67	61	55	49	43	37
SVH160-30-1	45		100	96	94	92	89	84	79	75	70	64	58	50	42
SVH160-30	45		107	103	101	99	96	93	90	85	79	73	66	58	50
SVH160-40-2	55		129	124	121	117	112	106	100	94	87	79	71	61	51
SVH160-40-1	55		136	133	130	126	122	117	112	105	98	90	81	70	60
SVH160-40	75		142	137	134	131	128	123	118	112	105	97	88	78	67
SVH160-50-2	75		166	163	159	154	148	142	135	127	118	108	96	83	70
SVH160-50	75		175	173	171	168	164	158	151	142	133	122	111	97	83
SVH160-60	90		212	209	205	201	196	190	181	171	159	147	133	115	98
SVH160-70	110		247	244	241	236	231	222	212	200	188	171	154	135	115
SVH160-80-2	110		272	267	262	256	249	238	226	213	198	180	161	141	120

# Vertical Multistage Centrifugal Pump — SVH | SVHT 160

## Structure SVH / SVHT 100,130,160,190

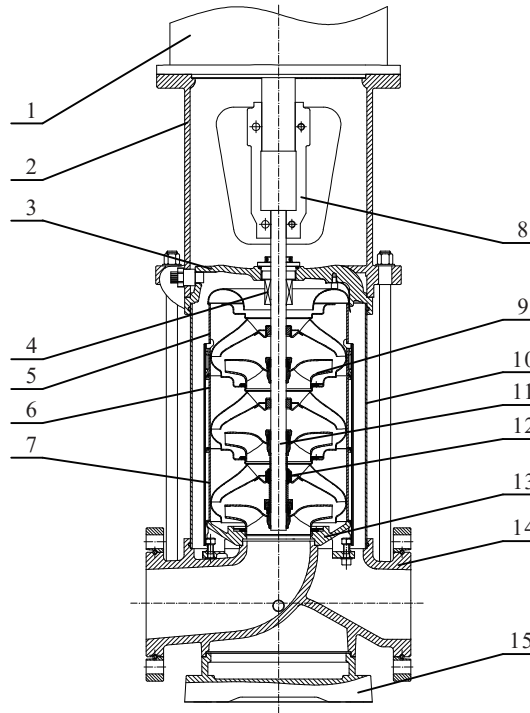

## Materials SVH / SVHT 100,130,160,190

No.	Spare parts	Materials		GB		EN DIN		AISI/ASTM	
		SVHT	SVH	SVHT	SVH	SVHT	SVH	SVHT	SVH
1	Motor	/		/		/		/	
2	Bracket	Ductile cast iron		GB 1348-QT500-7		EN 1563 EN-GJS-500-7		ASTMA53665-45-12	
3	Seal base	Ductile cast iron /Stainless steel		GB1348-QT500-7 /GB/T20878-06Cr19Ni10		EN 1563 EN-GJS-500-7 /EN 10088-1.4301		ASTM A536 65-45-12 /AISI304	
4	Mechanical seal	/		/		/		/	
5	Top diffuser	Stainless steel		GB/T20878-06Cr19Ni10		EN 10088-1.4301		AISI304	
6	Diffuser	Stainless steel		GB/T20878-06Cr19Ni10		EN 10088-1.4301		AISI304	
7	Support diffuser	Stainless steel		GB/T20878-06Cr19Ni10		EN 10088-1.4301		AISI304	
8	Coupling	Ductile cast iron		GB 1348-QT500-7		EN 1563 EN-GJS-500-7		ASTMA536 65-45-12	
9	Impeller	Stainless steel		GB/T20878-06Cr19Ni10		EN 10088-1.4301		AISI304	
10	Cylinder	Stainless steel		GB/T20878-06Cr19Ni10		EN 10088-1.4301		AISI304	
11	Shaft	Stainless steel		GB/T20878-06Cr19Ni10		EN 10088-1.4301		AISI304	
12	Bearing	WC/SiC		/		/		/	
13	Inducer	Stainless steel		GB/T20878-06Cr19Ni10		EN 10088-1.4301		AISI304	
14	Intel&outlet chamber	Ductile castiron /Stainless steel		GB1348-QT500-7 /GB/T20878-06Cr19Ni10		EN 1563 EN-GJS-500-7 /EN 10088-1.4301		ASTM A536 65-45-12 /AISI304	
15	Base	Ductile castiron		GB 1348-QT500-7		EN 1563 EN-GJS-500-7		ASTM A536 65-45-12	