

Vertical Multistage Centrifugal Pump — SVH | SVHT 16

Applications

Water supply

- Water filter
- Supercharging
- Pressurization of hotels
- Industrial pressurization

Industrial boosting

- Cleaning system
- High pressure flushing system
- Firefighting system
- Car cleaning equipment

Industrial liquid transport

- Cooling air conditioning system
- Boiler feed water
- Condensing system and cooling tower
- Machine tool cooling lubrication system

Water treatment

- Ultrafiltration system
- Reverse osmosis system
- Distillation system
- Separator
- Swimming pool

Irrigation

- Regional irrigation
- Sprinkler irrigation
- Drip irrigation
- Greenhouse irrigation

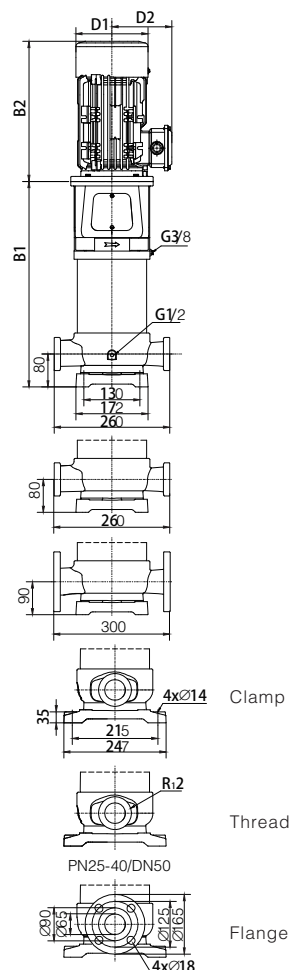

Dimensions and Weight

Model	Dimension (mm)					Weight (kg)
	B1	B2	B1+B2	D1	D2	
SVH16-20-2	401	350	751	190	155	51
SVH16-20	411	410	821	196	165	58
SVH16-30	456	410	866	230	185	68
SVH16-40	521	465	986	260	210	93
SVH16-50-2	566	465	1031	260	210	94
SVH16-50	566	465	1031	260	210	101
SVH16-60	611	465	1076	260	210	102
SVH16-70	745	610	1355	350	260	159
SVH16-80	790	610	1400	350	260	159
SVH16-90	835	610	1445	350	260	160
SVH16-100	880	610	1490	350	260	168
SVH16-110	925	610	1535	350	260	169
SVH16-120	970	610	1580	350	260	171
SVH16-130	1015	640	1655	350	260	194
SVH16-140	1060	640	1700	350	260	195
SVH16-150	1105	670	1775	360	285	228
SVH16-160	1150	670	1820	360	285	229
SVH16-170	1195	670	1865	360	285	231



G PUMP

Vertical Multistage Centrifugal Pump — SVH | SVHT 16

Performance cruve

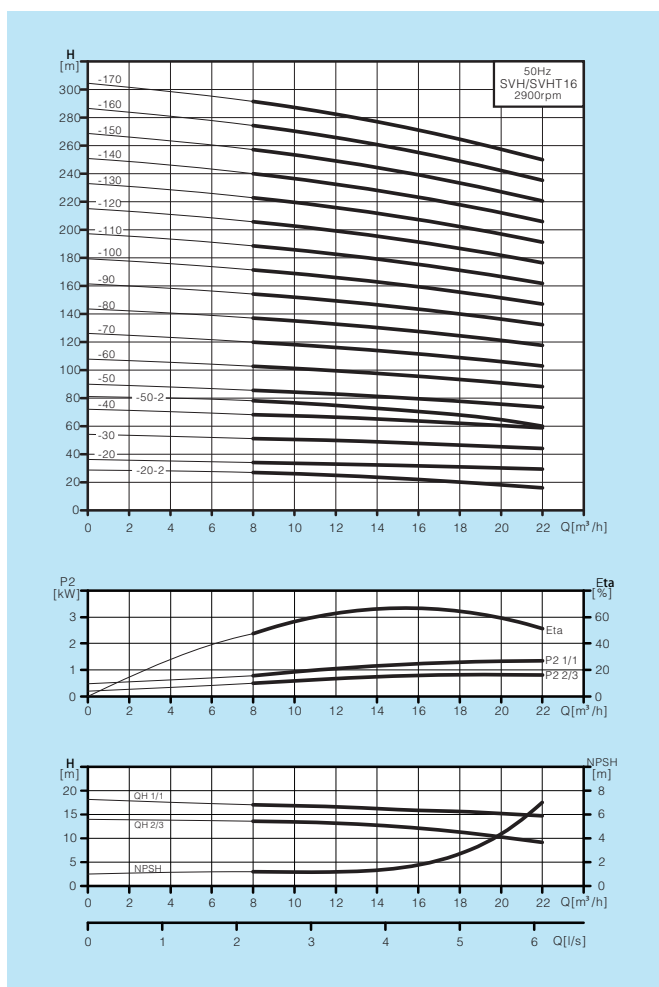

Model Specification

SVH,SVHT1/2/3/4/5/8/10/12/15/16/20

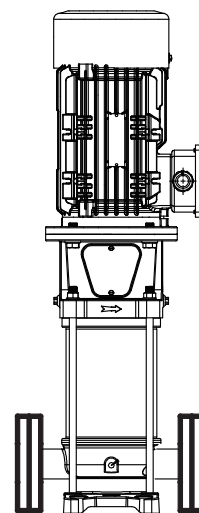

SVH / SVHT

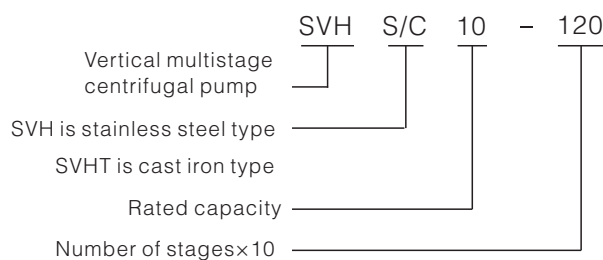

Performance data

Model	Power(kW)	Q (m³/h)	8	10	12	14	16	18	20	22
SVH16-20-2	2.2		27	26	25	24	22	21	19	16
SVH16-20	3		34	33.5	33	32.5	32	31	30	29
SVH16-30	4		51	50.5	50	48.5	48	47	46	44
SVH16-40	5.5		68	67	66	64.5	63.5	63	61	59
SVH16-50-2	5.5		78	77	75	73	70	68	65	60
SVH16-50	7.5		85	84	83	81	79	78	76	74
SVH16-60	7.5		102	101	100	97	95	94	91	88
SVH16-70	11		119	118	116	113	110	109	106	103
SVH16-80	11	H	136	135	133	129	126	125	122	118
SVH16-90	11	(m)	153	152	149	145	142	141	137	132
SVH16-100	15		170	168	166	161	158	156	152	147
SVH16-110	15		187	185	183	178	173	172	167	162
SVH16-120	15		204	202	199	194	189	188	183	176
SVH16-130	18.5		222	219	216	210	205	203	198	191
SVH16-140	18.5		239	236	233	226	221	219	213	206
SVH16-150	22		256	253	250	242	237	235	229	220
SVH16-160	22		273	270	267	258	253	250	244	235
SVH16-170	22		290	287	284	274	269	266	259	250

Vertical Multistage Centrifugal Pump — SVH | SVHT 16

Structure SVH / SVHT 8,10,12,15,16,20

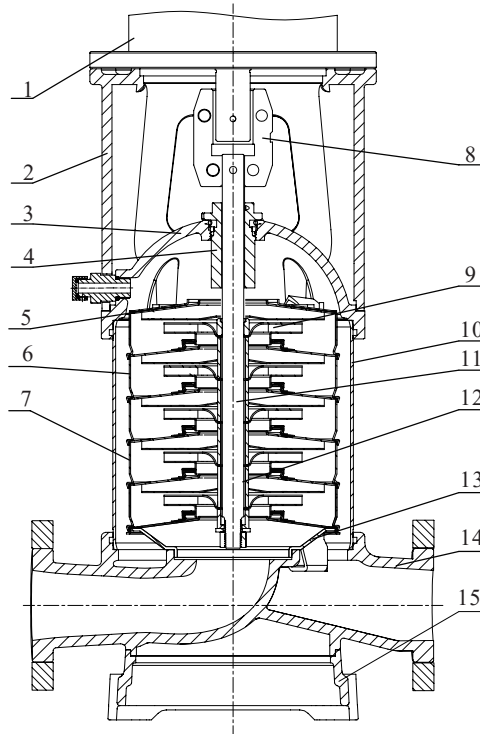

Materials SVH / SVHT 8,10,12,15,16,20

No.	Spare parts	Materials		GB		EN DIN		AISI/ASTM	
		SVHT	SVH	SVHT	SVH	SVHT	SVH	SVHT	SVH
1	Motor	/		/		/		/	
2	Bracket	Ductile cast iron		GB 1348-QT500-7		EN 1563 EN-GJS-500-7		ASTM A536 65-45-12	
3	Seal base	Ductile cast iron /Stainless steel		GB1348-QT500-7 /GB/T20878-06Cr19Ni10		EN 1563 EN-GJS-500-7 /EN 10088-1.4301		ASTM A536 65-45-12 /AISI304	
4	Mechanical seal	/		/		/		/	
5	Top diffuser	Stainless steel		GB/T20878-06Cr19Ni10		EN 10088-1.4301		AISI304	
6	Diffuser	Stainless steel		GB/T20878-06Cr19Ni10		EN 10088-1.4301		AISI304	
7	Support diffuser	Stainless steel		GB/T20878-06Cr19Ni10		EN 10088-1.4301		AISI304	
8	Coupling	Ductile cast iron		GB 1348-QT500-7		EN 1563 EN-GJS-500-7		ASTM A536 65-45-12	
9	Impeller	Stainless steel		GB/T20878-06Cr19Ni10		EN 10088-1.4301		AISI304	
10	Cylinder	Stainless steel		GB/T20878-06Cr19Ni10		EN 10088-1.4301		AISI304	
11	Shaft	Stainless steel		GB/T20878-06Cr19Ni10		EN 10088-1.4301		AISI304	
12	Bearing	WC/SiC		/		/		/	
13	Inducer	Stainless steel		GB/T20878-06Cr19Ni10		EN 10088-1.4301		AISI304	
14	Inlet & outlet chamber	Ductile cast iron /Stainless steel		GB1348-QT500-7 /GB/T20878-06Cr19Ni10		EN 1563 EN-GJS-500-7 /EN 10088-1.4301		ASTM A536 65-45-12 /AISI304	
15	Base	Ductile cast iron		GB 1348-QT500-7		EN 1563 EN-GJS-500-7		ASTM A536 65-45-12	