

Vertical Multistage Centrifugal Pump — SVH | SVHT 15

Applications

Water supply

- Water filter
- Supercharging
- Pressurization of hotels
- Industrial pressurization

Industrial boosting

- Cleaning system
- High pressure flushing system
- Firefighting system
- Car cleaning equipment

Industrial liquid transport

- Cooling air conditioning system
- Boiler feed water
- Condensing system and cooling tower
- Machine tool cooling lubrication system

Water treatment

- Ultrafiltration system
- Reverse osmosis system
- Distillation system
- Separator
- Swimming pool

Irrigation

- Regional irrigation
- Sprinkler irrigation
- Drip irrigation
- Greenhouse irrigation

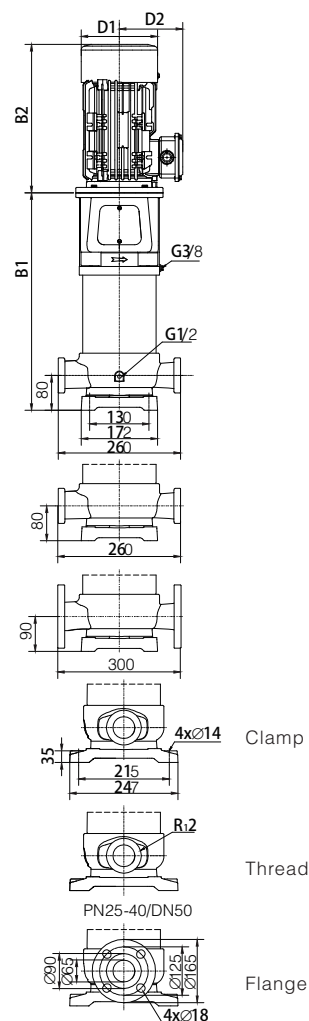

Dimensions and Weight

Model	Dimension (mm)					Weight (kg)
	B1	B2	B1+B2	D1	D2	
SVH15-10-1	346	280	626	170	142	39
SVH15-10	356	350	706	190	155	45
SVH15-20-2	401	350	751	190	155	51
SVH15-20	411	410	821	196	165	58
SVH15-30	456	410	866	230	185	68
SVH15-40-1	501	410	911	230	185	69
SVH15-40	521	465	986	260	210	93
SVH15-50	566	465	1031	260	210	94
SVH15-60	611	465	1076	260	210	102
SVH15-70-1	656	465	1121	260	210	103
SVH15-70	745	610	1355	350	260	158
SVH15-80	790	610	1400	350	260	159
SVH15-90	835	610	1445	350	260	160
SVH15-100	880	610	1490	350	260	161
SVH15-110-2	925	610	1535	350	260	162
SVH15-110	925	610	1535	350	260	171
SVH15-120	970	610	1580	350	260	172
SVH15-130	1015	610	1625	350	260	173
SVH15-140-2	1060	610	1670	350	260	174
SVH15-140	1060	640	1700	350	260	196
SVH15-150	1105	640	1745	350	260	197
SVH15-160	1150	640	1790	350	260	198
SVH15-170	1195	670	1865	360	285	232
SVH15-180	1240	670	1910	360	285	233



G PUMP

Vertical Multistage Centrifugal Pump — SVH | SVHT 15

Performance cruve

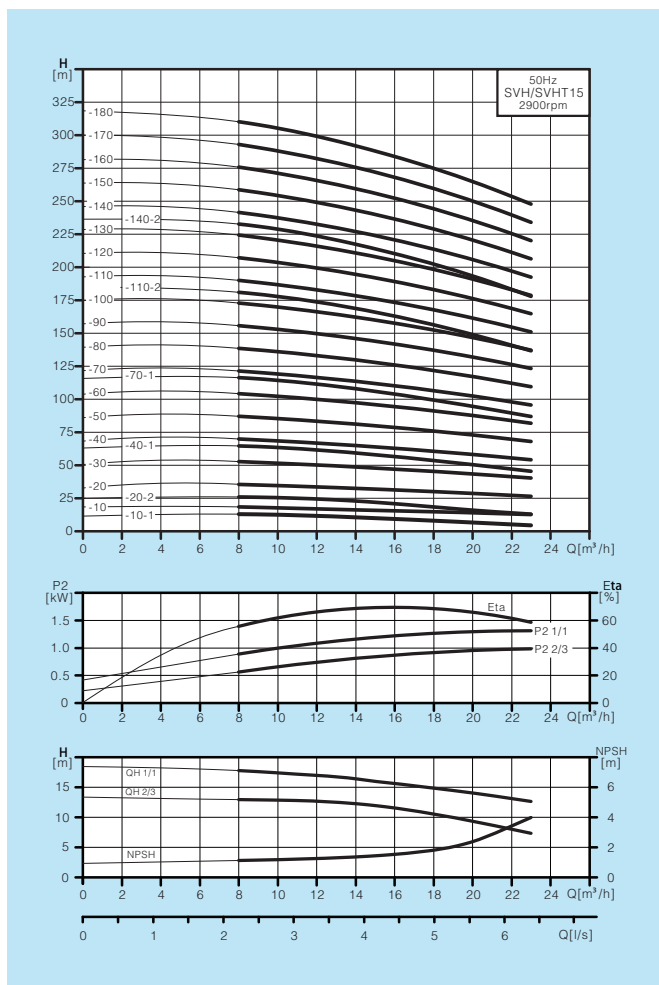

Model Specification

SVH,SVHT1/2/3/4/5/8/10/12/15/16/20

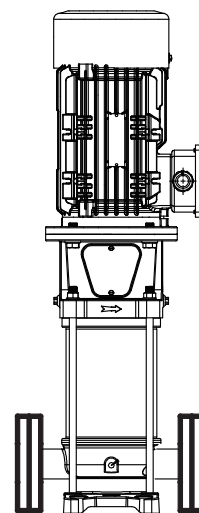

SVH / SVHT

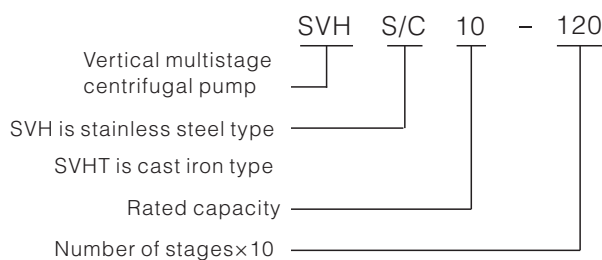

Performance data

Model	Power(kW)	Q (m³/h)	8	10	12	14	15	16	18	20	23
SVH15-10-1	1.1	H (m)	13	12	11.5	10.5	10	9	7.5	6	4.5
SVH15-10	1.5		17.5	17	16.6	16.3	16	15.5	15	14.5	14
SVH15-20-2	2.2		26	25	24	23	22	20.5	18	16	13
SVH15-20	3		34.5	34	33	32.5	32	31.5	30.5	29.5	28
SVH15-30	4		52	51	50	49	48	47.5	46	44.5	41
SVH15-40-1	4		65	63	61	59	58	57	54	51	46
SVH15-40	5.5		69	68	66.5	65	64	63	61	59	55
SVH15-50	5.5		86	85	83	81	80	79	77	74	69
SVH15-60	7.5		103	102	100	98	96	95	92	89	83
SVH15-70-1	7.5		116	114	111	108	106	104	99	95	87
SVH15-70	11		121	119	116	114	112	111	107	104	96
SVH15-80	11		138	136	133	130	128	127	122	118	110
SVH15-90	11		155	153	149	146	144	143	138	133	124
SVH15-100	11		172	170	166	163	160	158	153	148	138
SVH15-110-2	11		181	178	173	169	166	163	156	149	137
SVH15-110	15		190	187	183	179	176	174	168	163	151
SVH15-120	15		207	204	199	195	192	190	184	177	165
SVH15-130	15		224	221	216	212	208	206	199	192	179
SVH15-140-2	15		233	229	223	218	214	211	202	193	178
SVH15-140	18.5		241	238	232	228	224	222	214	207	193
SVH15-150	18.5	258	255	249	244	240	238	230	222	206	
SVH15-160	18.5	276	272	266	260	256	253	245	237	220	
SVH15-170	22	293	288	282	277	272	269	260	251	234	
SVH15-180	22	310	305	299	293	288	285	275	266	248	

Vertical Multistage Centrifugal Pump — SVH | SVHT 15

Structure SVH / SVHT 8,10,12,15,16,20

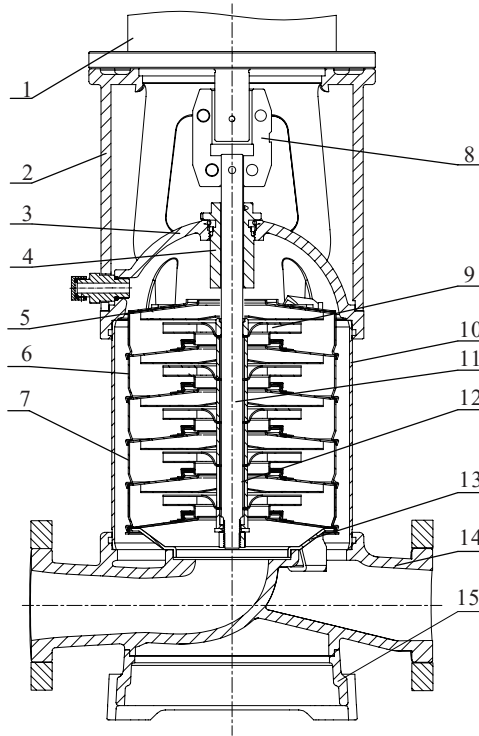

Materials SVH / SVHT 8,10,12,15,16,20

No.	Spare parts	Materials		GB		EN DIN		AISI/ASTM	
		SVHT	SVH	SVHT	SVH	SVHT	SVH	SVHT	SVH
1	Motor	/		/		/		/	
2	Bracket	Ductile cast iron		GB 1348-QT500-7		EN 1563 EN-GJS-500-7		ASTM A536 65-45-12	
3	Seal base	Ductile cast iron /Stainless steel		GB1348-QT500-7 /GB/T20878-06Cr19Ni10		EN 1563 EN-GJS-500-7 /EN 10088-1.4301		ASTM A536 65-45-12 /AISI304	
4	Mechanical seal	/		/		/		/	
5	Top diffuser	Stainless steel		GB/T20878-06Cr19Ni10		EN 10088-1.4301		AISI304	
6	Diffuser	Stainless steel		GB/T20878-06Cr19Ni10		EN 10088-1.4301		AISI304	
7	Support diffuser	Stainless steel		GB/T20878-06Cr19Ni10		EN 10088-1.4301		AISI304	
8	Coupling	Ductile cast iron		GB 1348-QT500-7		EN 1563 EN-GJS-500-7		ASTM A536 65-45-12	
9	Impeller	Stainless steel		GB/T20878-06Cr19Ni10		EN 10088-1.4301		AISI304	
10	Cylinder	Stainless steel		GB/T20878-06Cr19Ni10		EN 10088-1.4301		AISI304	
11	Shaft	Stainless steel		GB/T20878-06Cr19Ni10		EN 10088-1.4301		AISI304	
12	Bearing	WC/SiC		/		/		/	
13	Inducer	Stainless steel		GB/T20878-06Cr19Ni10		EN 10088-1.4301		AISI304	
14	Inlet & outlet chamber	Ductile cast iron /Stainless steel		GB1348-QT500-7 /GB/T20878-06Cr19Ni10		EN 1563 EN-GJS-500-7 /EN 10088-1.4301		ASTM A536 65-45-12 /AISI304	
15	Base	Ductile cast iron		GB 1348-QT500-7		EN 1563 EN-GJS-500-7		ASTM A536 65-45-12	