

Vertical Multistage Centrifugal Pump — SVH | SVHT 12

Applications

Water supply

- Water filter
- Supercharging
- Pressurization of hotels
- Industrial pressurization

Industrial boosting

- Cleaning system
- High pressure flushing system
- Firefighting system
- Car cleaning equipment

Industrial liquid transport

- Cooling air conditioning system
- Boiler feed water
- Condensing system and cooling tower
- Machine tool cooling lubrication system

Water treatment

- Ultrafiltration system
- Reverse osmosis system
- Distillation system
- Separator
- Swimming pool

Irrigation

- Regional irrigation
- Sprinkler irrigation
- Drip irrigation
- Greenhouse irrigation

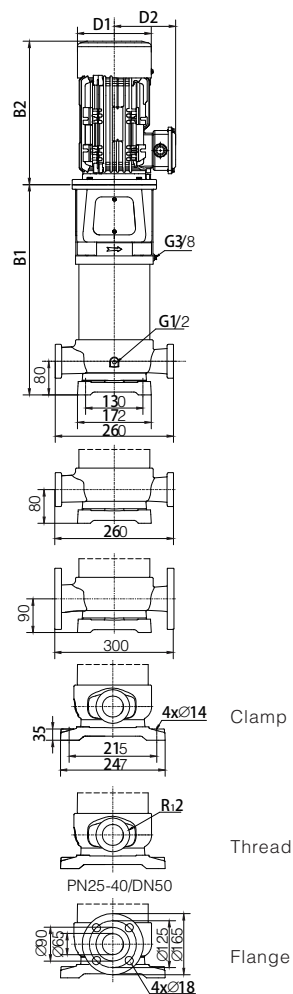

Dimensions and Weight

Model	Dimension (mm)					Weight (kg)
	B1	B2	B1+B2	D1	D2	
SVH12-20-2	365	350	715	190	155	47
SVH12-20	365	350	715	190	155	51
SVH12-30	405	410	815	196	165	58
SVH12-40-2	435	410	845	196	165	59
SVH12-40	435	410	845	230	185	68
SVH12-50	485	465	950	260	210	94
SVH12-60	515	465	980	260	210	95
SVH12-70	545	465	1010	260	210	103
SVH12-80	575	465	1040	260	210	104
SVH12-90	694	610	1304	350	260	159
SVH12-100	724	610	1334	350	260	160
SVH12-110	754	610	1364	350	260	161
SVH12-120	784	610	1394	350	260	163
SVH12-130	814	610	1424	350	260	171
SVH12-140	844	610	1454	350	260	172
SVH12-150	874	610	1484	350	260	173
SVH12-160	904	610	1514	350	260	174
SVH12-170	934	610	1544	350	260	175
SVH12-180	964	640	1604	350	260	198
SVH12-190	994	640	1634	350	260	199
SVH12-200	1024	640	1664	350	260	200



G PUMP

Vertical Multistage Centrifugal Pump — SVH | SVHT 12

Performance cruve

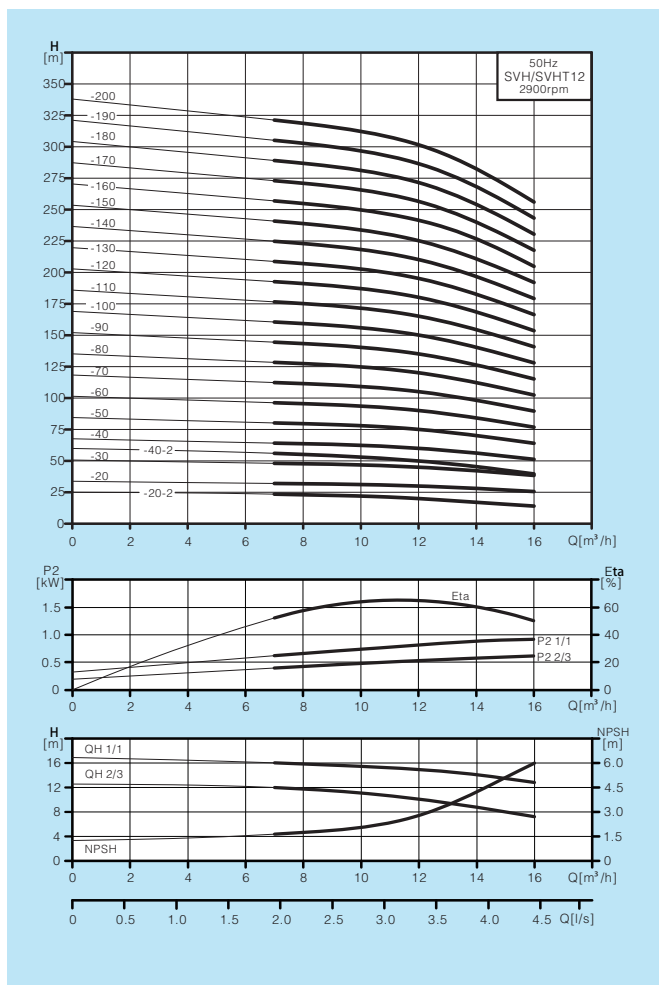

Model Specification

SVH,SVHT1/2/3/4/5/8/10/12/15/16/20

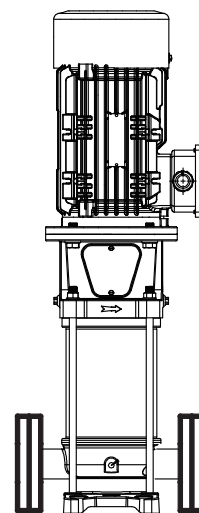

SVH / SVHT

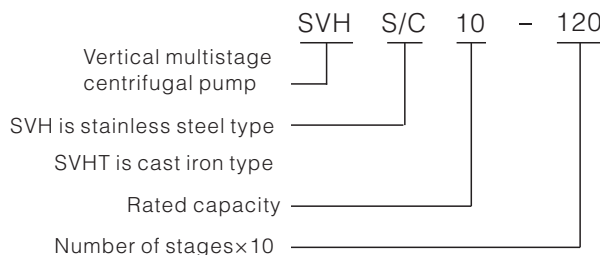

Performance data

Model	Power(kW)	Q (m³/h)	7	8	9	10	11	12	13	14	15	16
SVH12-20-2	1.5	H (m)	24	23	23	22	21	20	19	17	16	14
SVH12-20	2.2		32.5	32	31.5	31	30.5	30	29	28	27	26
SVH12-30	3		48	47.5	47	46.5	46	45	44	42	41	38
SVH12-40-2	3		56	55	54	53	52	50	48	45	43	40
SVH12-40	4		64	63.5	63	62	61	60	59	56	54	51
SVH12-50	5.5		80	79.5	79	78	77	75	74	71	68	64
SVH12-60	5.5		96	95	94	93	92	90	88	85	81	77
SVH12-70	7.5		112	111	110	109	107	105	103	99	95	90
SVH12-80	7.5		128	127	126	124	122	120	118	113	108	102
SVH12-90	11		144	143	141	140	138	135	132	127	122	115
SVH12-100	11		160	159	157	155	153	150	147	141	135	128
SVH12-110	11		176	175	173	171	168	165	162	155	149	141
SVH12-120	11		192	191	188	186	184	180	176	169	162	154
SVH12-130	15		208	207	204	202	199	195	191	183	176	166
SVH12-140	15		224	223	220	217	214	210	206	197	189	179
SVH12-150	15		240	239	236	233	230	225	221	212	203	192
SVH12-160	15		256	254	251	248	245	240	235	226	216	205
SVH12-170	15		272	270	267	264	260	255	250	240	230	217
SVH12-180	18.5		288	286	283	279	276	270	265	254	243	230
SVH12-190	18.5		304	302	298	295	291	285	279	268	257	243
SVH12-200	18.5	320	318	314	310	306	300	294	282	270	256	

Vertical Multistage Centrifugal Pump — SVH | SVHT 12 —

Structure SVH / SVHT 8,10,12,15,16,20

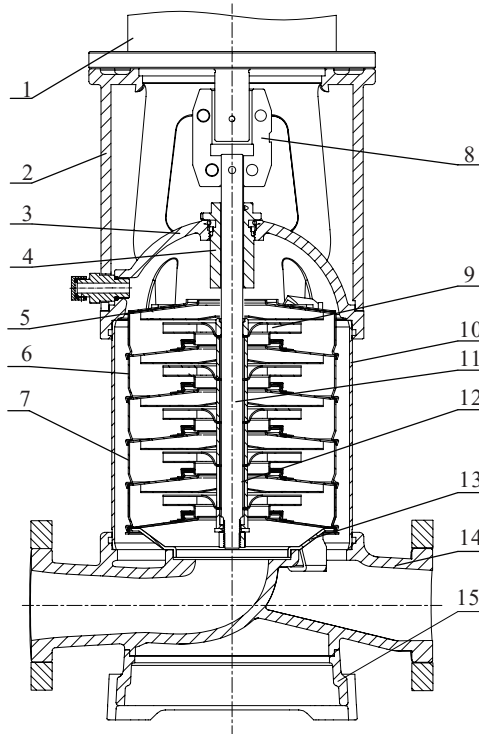

Materials SVH / SVHT 8,10,12,15,16,20

No.	Spare parts	Materials		GB		EN DIN		AISI/ASTM	
		SVHT	SVH	SVHT	SVH	SVHT	SVH	SVHT	SVH
1	Motor	/		/		/		/	
2	Bracket	Ductile cast iron		GB 1348-QT500-7		EN 1563 EN-GJS-500-7		ASTM A536 65-45-12	
3	Seal base	Ductile cast iron /Stainless steel		GB1348-QT500-7 /GB/T20878-06Cr19Ni10		EN 1563 EN-GJS-500-7 /EN 10088-1.4301		ASTM A536 65-45-12 /AISI304	
4	Mechanical seal	/		/		/		/	
5	Top diffuser	Stainless steel		GB/T20878-06Cr19Ni10		EN 10088-1.4301		AISI304	
6	Diffuser	Stainless steel		GB/T20878-06Cr19Ni10		EN 10088-1.4301		AISI304	
7	Support diffuser	Stainless steel		GB/T20878-06Cr19Ni10		EN 10088-1.4301		AISI304	
8	Coupling	Ductile cast iron		GB 1348-QT500-7		EN 1563 EN-GJS-500-7		ASTM A536 65-45-12	
9	Impeller	Stainless steel		GB/T20878-06Cr19Ni10		EN 10088-1.4301		AISI304	
10	Cylinder	Stainless steel		GB/T20878-06Cr19Ni10		EN 10088-1.4301		AISI304	
11	Shaft	Stainless steel		GB/T20878-06Cr19Ni10		EN 10088-1.4301		AISI304	
12	Bearing	WC/SiC		/		/		/	
13	Inducer	Stainless steel		GB/T20878-06Cr19Ni10		EN 10088-1.4301		AISI304	
14	Inlet & outlet chamber	Ductile cast iron /Stainless steel		GB1348-QT500-7 /GB/T20878-06Cr19Ni10		EN 1563 EN-GJS-500-7 /EN 10088-1.4301		ASTM A536 65-45-12 /AISI304	
15	Base	Ductile cast iron		GB 1348-QT500-7		EN 1563 EN-GJS-500-7		ASTM A536 65-45-12	