



G PUMP

## Vertical Multistage Centrifugal Pump — SVH | SVHT 100

### Applications

Water supply

- Water filter
- Supercharging
- Pressurization of hotels
- Industrial pressurization

Industrial boosting

- Cleaning system
- High pressure flushing system
- Firefighting system
- Car cleaning equipment

Industrial liquid transport

- Cooling air conditioning system
- Boiler feed water
- Condensing system and cooling tower
- Machine tool cooling lubrication system

Water treatment

- Ultrafiltration system
- Reverse osmosis system
- Distillation system
- Separator
- Swimming pool

Irrigation

- Regional irrigation
- Sprinkler irrigation
- Drip irrigation
- Greenhouse irrigation

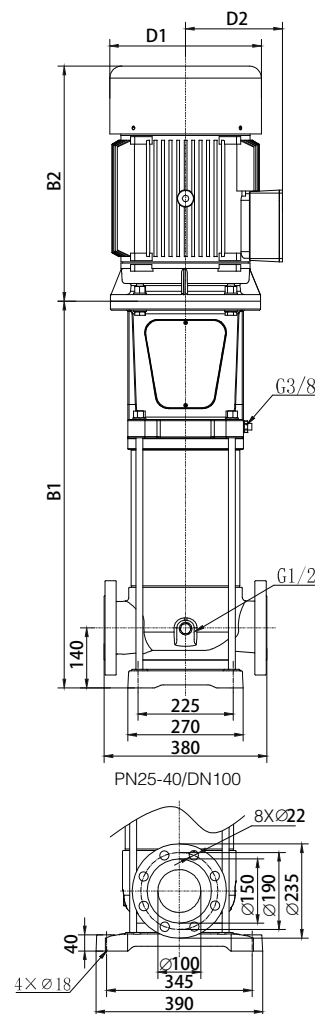

### Dimensions and Weight

Model	Dimension ( mm )					Weight (kg)
	B1	B2	B1+B2	D1	D2	
SVH100-10-1	592	465	1057	260	210	120
SVH100-10	592	465	1057	260	210	127
SVH100-20-2	797	610	1407	350	260	188
SVH100-20	797	610	1407	350	260	195
SVH100-30-2	902	640	1542	360	285	223
SVH100-30	902	670	1572	360	285	256
SVH100-40-2	1007	715	1722	400	310	332
SVH100-40	1007	715	1722	400	310	332
SVH100-50-2	1112	715	1827	400	310	351
SVH100-50	1112	715	1827	400	310	351
SVH100-60-2	1217	740	1957	460	340	431
SVH100-60	1217	740	1957	460	340	431
SVH100-70-2	1352	820	2172	550	370	540
SVH100-70	1352	820	2172	550	370	540
SVH100-80-2	1457	820	2277	550	370	545
SVH100-80	1457	870	2327	580	410	660
SVH100-90-2	1562	870	2432	580	410	665
SVH100-90	1562	870	2432	580	410	665
SVH100-100-2	1667	870	2537	580	410	671
SVH100-100	1667	870	2537	580	410	671



G PUMP

# Vertical Multistage Centrifugal Pump — SVH | SVHT 100

## Performance cruve

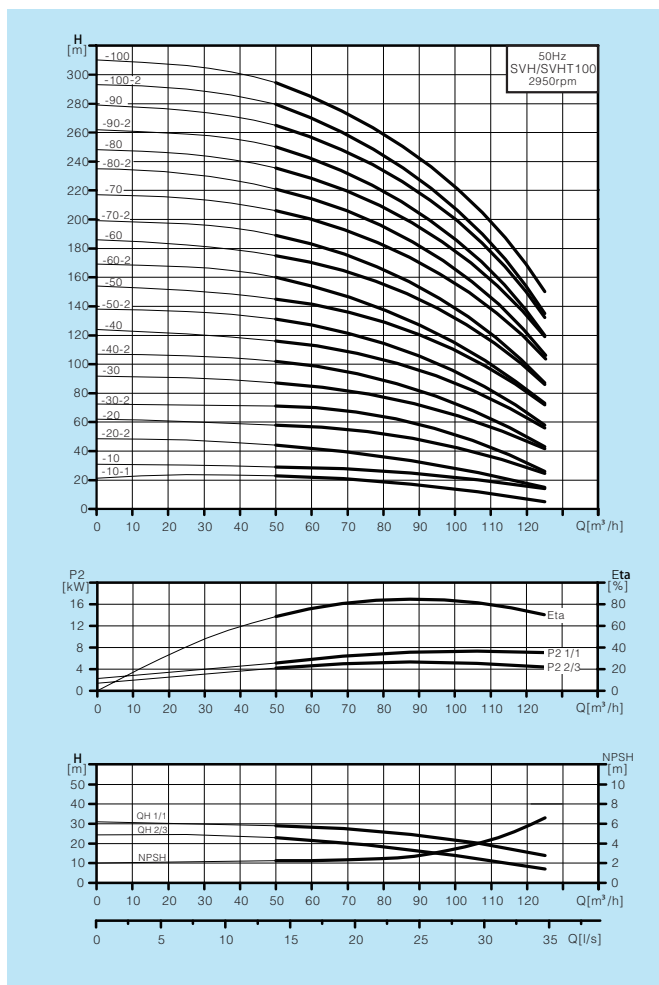

## Model Specification

SVH, SVHT 100/130/160/190

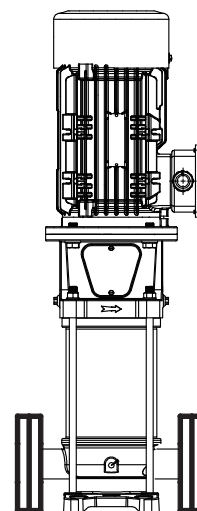

## SVH / SVHT

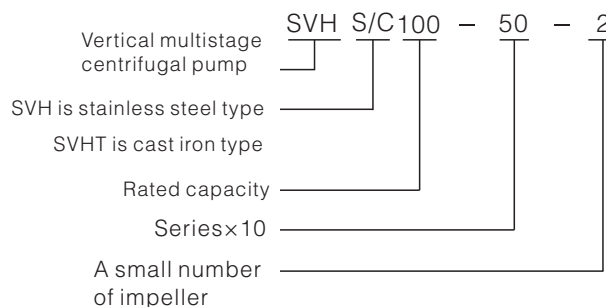

## Performance data

Model	Power(kW)	Q (m³/h)	50	60	70	80	90	100	110	120	125
SVH100-10-1	5.5	H (m)	23	22	20	18	16	14	11	8	7
SVH100-10	7.5		29	28	27	26	24	22	18	16	14
SVH100-20-2	11		44	43	41	38	34	28	23	17	15
SVH100-20	15		58	56	54	52	49	43	37	31	28
SVH100-30-2	18.5		71	68	66	62	57	52	42	31	26
SVH100-30	22		87	84	81	78	73	65	56	48	43
SVH100-40-2	30		102	99	95	90	83	71	60	48	43
SVH100-40	30		116	113	109	104	97	87	76	64	58
SVH100-50-2	37		131	127	122	116	107	93	79	65	58
SVH100-50	37		145	141	136	130	122	109	96	80	72
SVH100-60-2	45		160	156	150	142	131	115	99	81	73
SVH100-60	45		175	170	164	157	146	132	115	96	89
SVH100-70-2	55		189	184	177	168	156	137	119	97	87
SVH100-70	55		206	202	193	183	172	156	138	114	105
SVH100-80-2	55		221	215	207	197	182	165	142	115	103
SVH100-80	75		235	231	221	209	197	178	158	130	120
SVH100-90-2	75		250	245	234	221	206	184	161	131	120
SVH100-90	75		265	260	248	235	221	201	177	147	135
SVH100-100-2	75		279	274	262	247	231	206	181	147	135
SVH100-100	75		294	289	279	261	246	223	197	163	150

# Vertical Multistage Centrifugal Pump — SVH | SVHT 100

## Structure SVH / SVHT 100,130,160,190

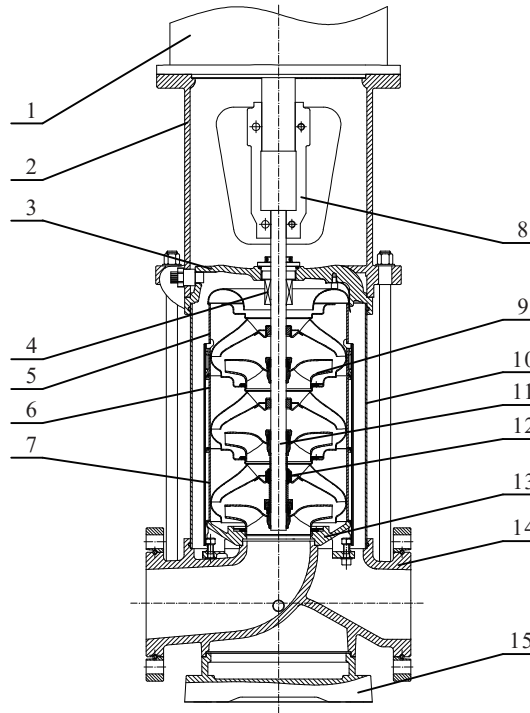

## Materials SVH / SVHT 100,130,160,190

No.	Spare parts	Materials		GB		EN DIN		AISI/ASTM	
		SVHT	SVH	SVHT	SVH	SVHT	SVH	SVHT	SVH
1	Motor	/		/		/		/	
2	Bracket	Ductile cast iron		GB 1348-QT500-7		EN 1563 EN-GJS-500-7		ASTMA53665-45-12	
3	Seal base	Ductile cast iron /Stainless steel		GB1348-QT500-7 /GB/T20878-06Cr19Ni10		EN 1563 EN-GJS-500-7 /EN 10088-1.4301		ASTM A536 65-45-12 /AISI304	
4	Mechanical seal	/		/		/		/	
5	Top diffuser	Stainless steel		GB/T20878-06Cr19Ni10		EN 10088-1.4301		AISI304	
6	Diffuser	Stainless steel		GB/T20878-06Cr19Ni10		EN 10088-1.4301		AISI304	
7	Support diffuser	Stainless steel		GB/T20878-06Cr19Ni10		EN 10088-1.4301		AISI304	
8	Coupling	Ductile cast iron		GB 1348-QT500-7		EN 1563 EN-GJS-500-7		ASTMA53665-45-12	
9	Impeller	Stainless steel		GB/T20878-06Cr19Ni10		EN 10088-1.4301		AISI304	
10	Cylinder	Stainless steel		GB/T20878-06Cr19Ni10		EN 10088-1.4301		AISI304	
11	Shaft	Stainless steel		GB/T20878-06Cr19Ni10		EN 10088-1.4301		AISI304	
12	Bearing	WC/SiC		/		/		/	
13	Inducer	Stainless steel		GB/T20878-06Cr19Ni10		EN 10088-1.4301		AISI304	
14	Intel&outlet chamber	Ductile castiron /Stainless steel		GB1348-QT500-7 /GB/T20878-06Cr19Ni10		EN 1563 EN-GJS-500-7 /EN 10088-1.4301		ASTM A536 65-45-12 /AISI304	
15	Base	Ductile castiron		GB 1348-QT500-7		EN 1563 EN-GJS-500-7		ASTM A536 65-45-12	