

# Vertical Multistage Centrifugal Pump — SVH | SVHT 10

## Applications

Water supply

- Water filter
- Supercharging
- Pressurization of hotels
- Industrial pressurization

Industrial boosting

- Cleaning system
- High pressure flushing system
- Firefighting system
- Car cleaning equipment

Industrial liquid transport

- Cooling air conditioning system
- Boiler feed water
- Condensing system and cooling tower
- Machine tool cooling lubrication system

Water treatment

- Ultrafiltration system
- Reverse osmosis system
- Distillation system
- Separator
- Swimming pool

Irrigation

- Regional irrigation
- Sprinkler irrigation
- Drip irrigation
- Greenhouse irrigation

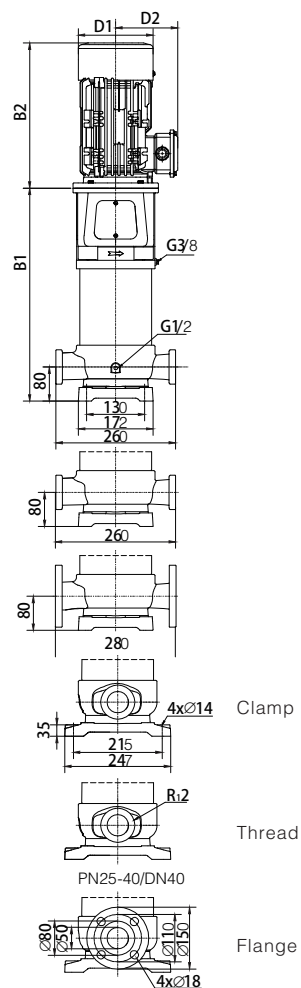

## Dimensions and Weight

Model	Dimension ( mm )					Weight (kg)
	B1	B2	B1+B2	D1	D2	
SVH10-20-2	355	280	635	170	142	37
SVH10-20	355	280	635	170	142	39
SVH10-30	395	350	745	170	142	47
SVH10-40	425	350	775	190	155	52
SVH10-50-2	455	350	805	190	155	53
SVH10-50	465	410	875	196	165	59
SVH10-60	495	410	905	196	165	60
SVH10-70	525	410	935	230	185	70
SVH10-80	555	410	965	230	185	71
SVH10-90	605	465	1070	260	210	98
SVH10-100	635	465	1100	260	210	99
SVH10-110	665	465	1130	260	210	100
SVH10-120	695	465	1160	260	210	108
SVH10-130	725	465	1190	260	210	109
SVH10-140	755	465	1220	260	210	110
SVH10-150	785	465	1250	260	210	111
SVH10-160-1	815	465	1280	260	210	112
SVH10-160	904	610	1514	350	260	167
SVH10-170	934	610	1544	350	260	168
SVH10-180	964	610	1574	350	260	169
SVH10-190	994	610	1604	350	260	170
SVH10-200	1024	610	1634	350	260	171
SVH10-210	1054	610	1664	350	260	173
SVH10-220	1084	610	1694	350	260	181
SVH10-230	1114	610	1724	350	260	182
SVH10-240	1144	610	1754	350	260	183
SVH10-250	1174	610	1784	350	260	184



G PUMP

# Vertical Multistage Centrifugal Pump — SVH | SVHT 10

## Performance cruve

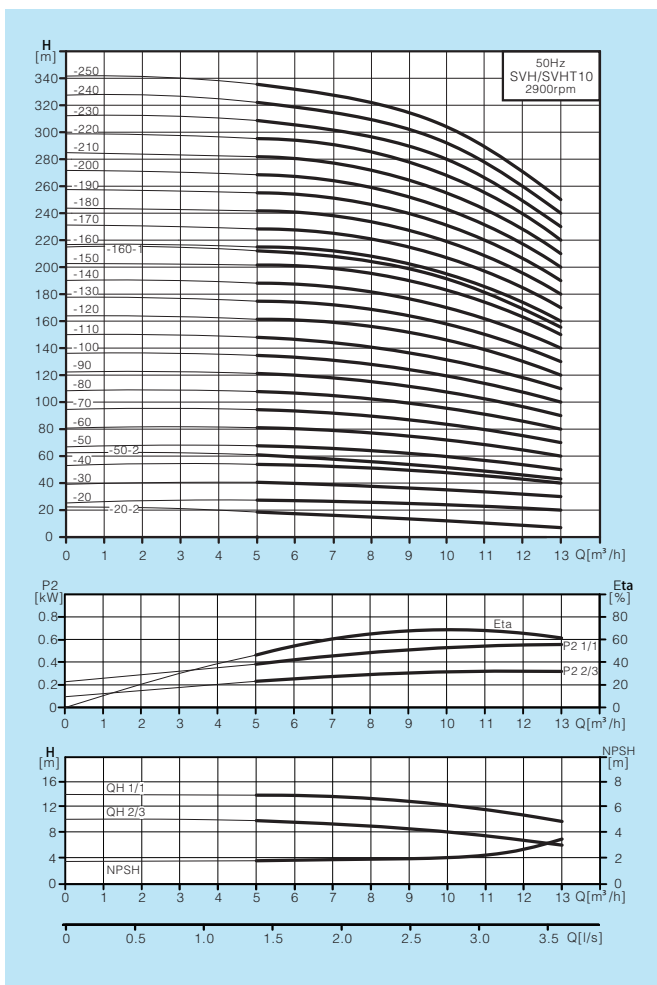

## Model Specification

SVH,SVHT1/2/3/4/5/8/10/12/15/16/20

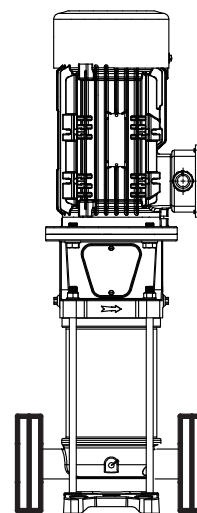

SVH / SVHT

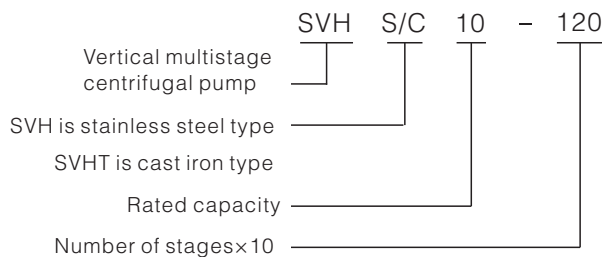

## Performance data

Model	Power(kW)	Q (m³/h)	5	6	7	8	9	10	11	12	13
SVH10-20-2	0.75	H (m)	18.5	17	16	14	13	12	10	8.5	7
SVH10-20	1.1		28	27	26	25.5	25	24	23	22	20
SVH10-30	1.5		41	40	39.5	38	37	35	34	32	30
SVH10-40	2.2		55	53	52	51	49.5	48	46	43	40
SVH10-50-2	2.2		61	59	58	56	54	51.5	49	47	43
SVH10-50	3		68	67	66	64	62	60	57	54	50
SVH10-60	3		82	79	78	77	74	72	69	65	60
SVH10-70	4		96	93	92	90	87	84	80	75	70
SVH10-80	4		109	107	105	103	99	96	91	86	80
SVH10-90	5.5		123	120	118	115	111	108	103	97	90
SVH10-100	5.5		137	134	131	128	124	120	114	108	100
SVH10-110	5.5		150	147	144	141	136	132	126	118	110
SVH10-120	7.5		164	160	157	154	149	144	137	129	120
SVH10-130	7.5		177	174	170	167	161	156	149	140	130
SVH10-140	7.5		191	187	183	179	173	168	160	151	140
SVH10-150	7.5		205	200	197	192	186	180	171	162	150
SVH10-160-1	7.5		214	208	205	199	192	186	176	166	153
SVH10-160	11		218	214	210	205	198	192	183	172	160
SVH10-170	11		232	227	223	218	210	204	194	183	170
SVH10-180	11		246	240	236	231	223	216	206	194	180
SVH10-190	11	259	254	249	244	235	228	217	205	190	
SVH10-200	11	273	267	262	256	248	240	229	215	200	
SVH10-210	11	287	280	275	269	260	252	240	226	210	
SVH10-220	15	300	294	288	282	272	264	251	237	220	
SVH10-230	15	309	305	301	297	290	280	266	249	230	
SVH10-240	15	322	319	314	309	302	292	278	260	240	
SVH10-250	15	335	332	327	322	314	304	289	271	250	

# Vertical Multistage Centrifugal Pump — SVH | SVHT 10

## Structure SVH / SVHT 8,10,12,15,16,20

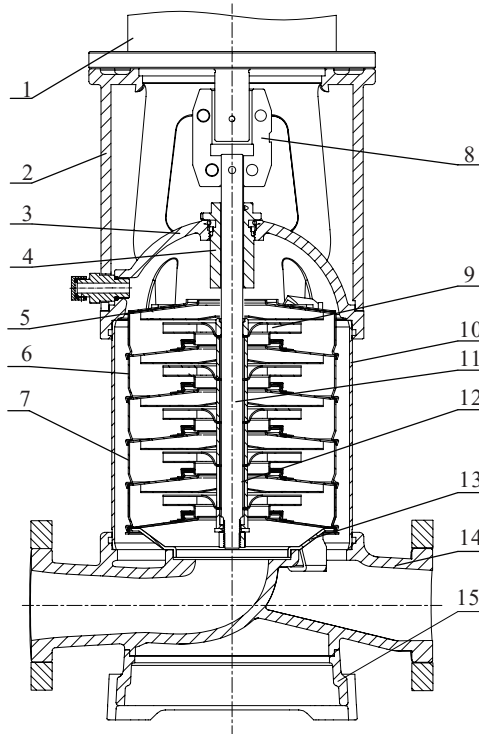

## Materials SVH / SVHT 8,10,12,15,16,20

No.	Spare parts	Materials		GB		EN DIN		AISI/ASTM	
		SVHT	SVH	SVHT	SVH	SVHT	SVH	SVHT	SVH
1	Motor	/		/		/		/	
2	Bracket	Ductile cast iron		GB 1348-QT500-7		EN 1563 EN-GJS-500-7		ASTM A536 65-45-12	
3	Seal base	Ductile cast iron /Stainless steel		GB1348-QT500-7 /GB/T20878-06Cr19Ni10		EN 1563 EN-GJS-500-7 /EN 10088-1.4301		ASTM A536 65-45-12 /AISI304	
4	Mechanical seal	/		/		/		/	
5	Top diffuser	Stainless steel		GB/T20878-06Cr19Ni10		EN 10088-1.4301		AISI304	
6	Diffuser	Stainless steel		GB/T20878-06Cr19Ni10		EN 10088-1.4301		AISI304	
7	Support diffuser	Stainless steel		GB/T20878-06Cr19Ni10		EN 10088-1.4301		AISI304	
8	Coupling	Ductile cast iron		GB 1348-QT500-7		EN 1563 EN-GJS-500-7		ASTM A536 65-45-12	
9	Impeller	Stainless steel		GB/T20878-06Cr19Ni10		EN 10088-1.4301		AISI304	
10	Cylinder	Stainless steel		GB/T20878-06Cr19Ni10		EN 10088-1.4301		AISI304	
11	Shaft	Stainless steel		GB/T20878-06Cr19Ni10		EN 10088-1.4301		AISI304	
12	Bearing	WC/SiC		/		/		/	
13	Inducer	Stainless steel		GB/T20878-06Cr19Ni10		EN 10088-1.4301		AISI304	
14	Inlet & outlet chamber	Ductile cast iron /Stainless steel		GB1348-QT500-7 /GB/T20878-06Cr19Ni10		EN 1563 EN-GJS-500-7 /EN 10088-1.4301		ASTM A536 65-45-12 /AISI304	
15	Base	Ductile cast iron		GB 1348-QT500-7		EN 1563 EN-GJS-500-7		ASTM A536 65-45-12	